

## WITH CONICAL CLAMPING RING

4.5 - 10 Nm



High speed

### PROPERTIES

#### FEATURES

- ▶ for high speeds
- ▶ self centering conical clamping ring design
- ▶ high balancing grade

#### DESIGN

Two hubs with conical clamping ring and three or four screws. Maximum speed up to 120,000 rpm.

#### MATERIAL

- ▶ **Bellows:** high grade stainless steel
- ▶ **Hubs and clamping rings:** aluminium

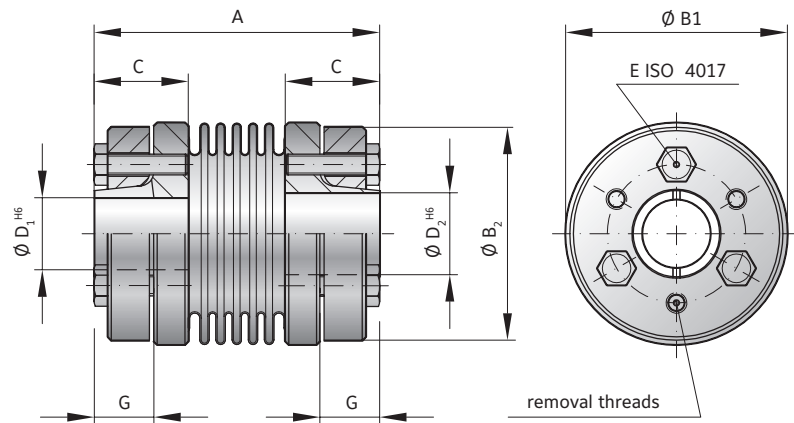

## MODELL MKS

SIZE			45	100	150	
Rated torque (Nm)	$T_{KN}$		4.5	10	15	
Overall length (mm)	A		42	48	53	
Outside diameter (mm)	$B_1$		32	40	49	
Outside diameter of hub (mm)	$B_2$		30	38	46	
Fit length (mm)	C		14	16	20	
Inside diameter possible from $\emptyset$ to $\emptyset$ H6 (mm)	$D_{1/2}$		6-10	8-14	10-19	
Fastening screw ISO 4017 (mm)			3x M3	4x M3	8x M3	
Tightening torque of the fastening screw (Nm)	E		1.3	1.3	1.3	
Distance (mm)	G		8.5	9.5	13	
Moment of inertia ( $gcm^2$ )	$J_{ges.}$		65	226	561	
Masse (g)			51	103	171	
Torsional stiffness (Nm/rad)	$C_T$		7000	9050	23000	
Axial (mm)			0.5	0.75	0.75	
Lateral (mm)	Max. values		0.1	0.05*	0.1	0.05*
Angular (degree)			0.5	0.5	0.5	

For speeds beyond 50,000 rpm use reduced misalignment values marked with \*

ORDERING EXAMPLE	MKS	45	8	9.53	XX
Model	●				
Size		●			
Bore D1 H6			●		
Bore D2 H6				●	
Special designation only (e.g. special bore tolerance).					
For custom features place an XX at the end of the part number and describe the special requirements (e.g. MKS / 45 / 8 / 9.53 / XX; XX=anodized aluminum hubs)					