

ST

SAFETY ELEMENT



PROPERTIES

MATERIAL

Hardened steel (nitrocarburized surface)

DESIGN

Two part assembly for installation into prefabricated coupling components.

Part 1: detent receptacle

Part 2: self-contained, spring loaded plunger module.

The spring force setting is adjustable in the field, with the settings clearly marked on an adjustment scale.

FIT TOLERANCE

For insertion of the safety elements H7 precision holes should be used for all centered components.

RE-ENGAGEMENT

When properly located over the detent receptacle the safety element can be re-engaged through the application of pressure to the back side of the plunger core.

Design:

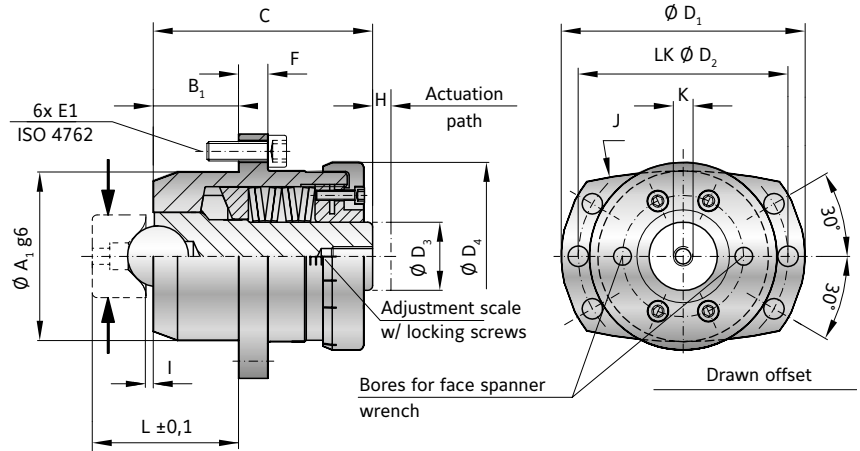
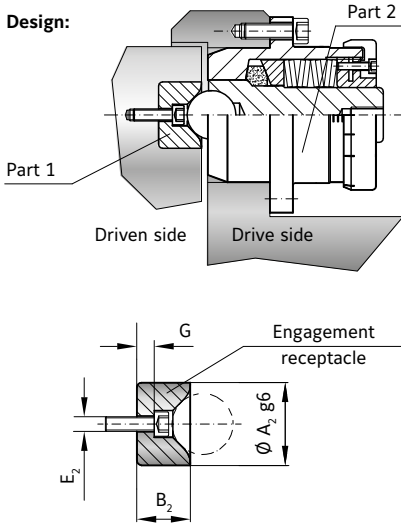

MODEL ST | SIZE 10 - 70

SIZE		10	15	30	70
Tangential force (KN) Adjustment range available from - to (ranges)	1	0.8-2.2	1-4	5-10	8-20
	2	-	2-8	10-20	15-40
	3	2.0-3.3	6-20	20-30	30-70
Centering diameter of safety element g6 (mm)	A ₁	28	40	70	90
Centering diameter engagement receptacle g6 (mm)	A ₂	18	24	34	44
Centering length of safety element (mm)	B ₁	15	20	35	45
Centering length engagement receptacle (mm)	B ₂	13.5	14	22	30
Overall length (mm)	C	56	70	103	135
Outside diameter (mm)	D ₁	45	59	100	129
Bolt circle diameter (mm)	D ₂	37.5	50	86	110
Diameter plunger (mm)	D ₃	8	16	28	35
Diameter adjustment nut (mm)	D ₄	32	44	75	92
Screw / Tightening torque ISO 4762 (mm)	E ₁	6 x M4 x 12 / 4.5 Nm	6 x M5 x 16 / 10 Nm	6 x M8 x 25 / 40 Nm	6 x M12 x 35 / 120 Nm
Screw / Tightening torque ISO 4762 (mm)	E ₂	M3 x 20 4.5 Nm	M4 x 14 4.5 Nm	M6 x 20 15.5 Nm	M8 x 25 38 Nm
Flange thickness (mm)	F	5	7	12	16
Distance (mm)	G	6.5	5	8	10
Actuation path (mm)	H	3	4	7.5	10
Distance (mm)	I	1.5	2	3	4
Radius (mm)	J	100	110	200	250
Inner thread (mm)	K	M5 x 10	M8 x 15	M10 x 25	M16 x 30
Distance ± 0,1 (mm)	L	30	36	60	79
Weight (kg)		0.26	0.65	2.7	6

axial spring force = tangential force/1.4

ORDERING EXAMPLE	ST	30	2	12	XX
Model	●				
Size		●			
Adjustment range 1/2/3			●		
Tangential force (KN)				●	
For custom features place an XX at the end of the part number and describe the special requirements (e.g. ST / 30 / 2 / 12 / XX)					

Special designation only
(e.g. stainless steel)