

LP2

WITH KEYWAY MOUNTING

350 - 5,200 Nm



PROPERTIES



FEATURES

- ▶ high torsional stiffness
- ▶ dual flex design
- ▶ customer specified length on request

MATERIAL

- ▶ **disc packs:** highly elastic spring steel
- ▶ **hubs and spacer:** high strength steel

DESIGN

Two precision machined coupling hubs and spacer mounted to the disc packs by means of high strength screws and bushings for alignment and frictional clamping of the assembly. Axial retention of the hubs on the shaft with DIN 916 set screws. From series 25,000 assembly screws/superbolts must be used.

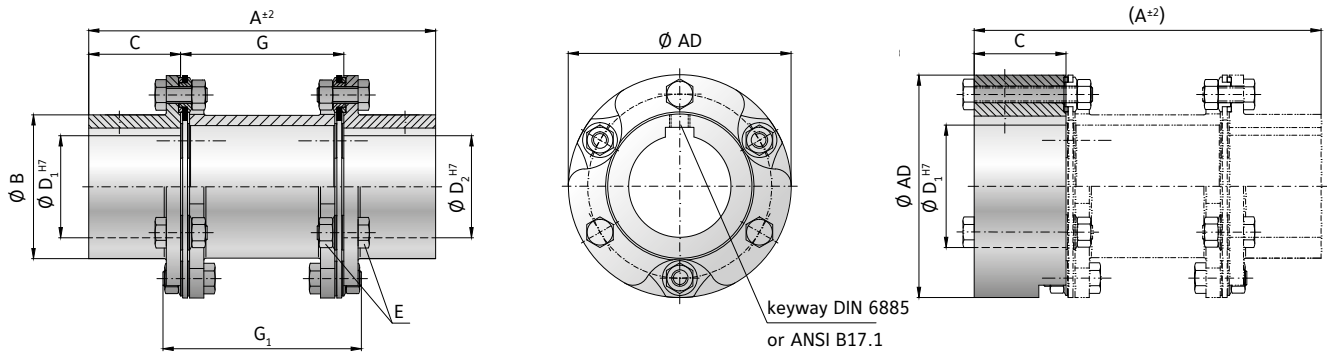

Optional XL Hub

NEW

MODEL LP2 | SIZE 300 - 2600

SIZE			300	500	700	1100	1600	2600
Rated torque	(Nm)	T_{KN}	350	500	700	1,100	1,600	2,600
Maximum torque	(Nm)	T_{KNmax}	700	1,000	1,400	2,200	3,200	5,200
Overall length	(mm)	A	170	170	205	206	286	286
Outside diameter	(mm)	$\varnothing AD$	99	109	128	133	150	168
Hub diameter	(mm)	$\varnothing B$	63	70.5	78	84	86	102
Hub fit length	(mm)	C	45	45	55	55	75	76
Bore diameter available from \varnothing to $\varnothing H7$	(mm)	$D_{1/2}$	18 - 48	23 - 50	25 - 58	25 - 60	28 - 64	31 - 75
Bore diameter available from \varnothing to $\varnothing H7$ (XL Hub)	(mm)	$D_{1/2}$	> 48 - 53	> 50 - 60	> 58 - 65	> 60 - 70	> 64 - 80	> 75 - 90
Assembly screw Tensioning nut	(ISO 4017) (DIN 4032)	E	M8	M8	M10	M10	M12	M12
Tightening torque	(Nm)		35	40	65	95	150	165
Distance between hubs	(mm)	G	80	80	95	96	136	134
Assembly length	(mm)	G_1	100	100	123	124	166	162
Moment of inertia**	($10^{-3}kgm^2$)	$J_{ges.}$	4	5	9	11	20	35
Weight**	(kg)		2.6	3.5	4.8	5.4	8.5	12
Torsional stiffness disc packs	(kNm/rad)	C_1	100	140	235	270	400	600
Axial \pm	(mm)		1	1	1.5	1.5	2	2
Lateral \pm	(mm)	max. values	0.8	0.8	1	1	1.4	1.4
Angular \pm	(degree)		1.4	1.4	1.4	1.4	1.4	1.4
Max. speed	(min^{-1})		5,800	5,200	4,500	4,300	3,850	3,500
Max. speed (balanced)***	(min^{-1})		13,500	12,300	10,500	10,000	8,950	8,000

** at maximum bore diameter | *** higher speeds on request

ORDERING EXAMPLE	LP2	500	170	25.4	48	XX
Model	●					
Size		●				
Overall length (mm)			●			
Bore diameter $\varnothing D1 H7$				●		
Bore diameter $\varnothing D2 H7$					●	
Special designation only (e.g. special bore diameter tolerances, balancing, etc.). Contact R+W for more information.						
For custom features place an XX at the end of the part number and describe the special requirements (e.g. LP2 / 500 / 170 / 25.4 / 48 / XX - balanced for 10,000 rpm)						

LP2

WITH KEYWAY MOUNTING

4,000 - 50,000 Nm



PROPERTIES



FEATURES

- ▶ high torsional stiffness
- ▶ dual flex design
- ▶ customer specified length on request

MATERIAL

- ▶ **disc packs:** highly elastic spring steel
- ▶ **hubs and spacer:** high strength steel

DESIGN

Two precision machined coupling hubs and spacer mounted to the disc packs by means of high strength screws and bushings for alignment and frictional clamping of the assembly. Axial retention of the hubs on the shaft with DIN 916 set screws. From series 25,000 assembly screws/superbolts must be used.

Optional XL Hub

NEW

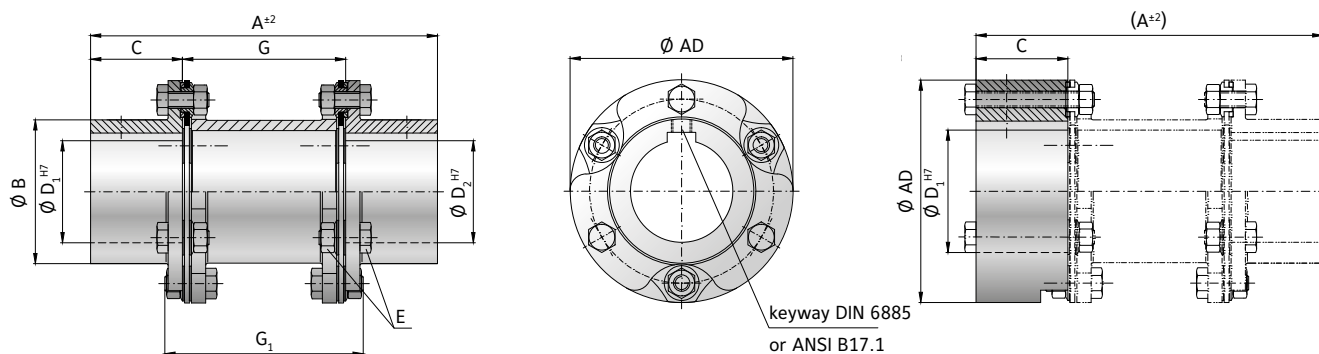

MODEL LP2 | SIZE 4000 - 25000

Higher torque capacity on request

SIZE			4000	6000	8000	15000	25000
Rated torque	(Nm)	T _{KN}	4,000	6,000	8,000	15,000	25,000
Maximum torque	(Nm)	T _{KNmax}	8,000	12,000	16,000	30,000	50,000
Overall length	(mm)	A	320	340	372	474	669,4
Outside diameter	(mm)	Ø AD	198	212	238	272	300
Hub diameter	(mm)	Ø B	120	130	140	182	189
Hub fit length	(mm)	C	90	90	100	125	165
Bore diameter available from Ø to Ø H7	(mm)	D _{1/2}	38 - 90	39 - 95	50 - 102	70 - 140	on request
Bore diameter available from Ø to Ø H7 (XL Hub)	(mm)	D _{1/2}	> 90 - 100	> 95 - 115	> 102 - 125	> 140 - 160	on request
Assembly screw (ISO 4017) Tensioning nut (DIN 4032)		E	M16	M16	M20	M20	M24
Tightening torque	(Nm)		360	400	755	770	47
Distance between hubs	(mm)	G	140	160	172	224	339,4
Assembly length	(mm)	G ₁	174	194	220	274,6	431,6
Moment of inertia**	(10 ⁻³ kgm ²)	J _{ges.}	81	109	216	448	on request
Weight**	(kg)		18,4	21,3	33	48,9	on request
Torsional stiffness disc packs	(kNm/rad)	C _T	1,000	1,250	1,800	3,850	8,000
Axial ±	(mm)		2.5	2.5	2.5	3	4
Lateral ±	(mm)	max, values	1.4	1.5	1.6	2.2	2.6
Angular ±	(degree)		1.4	1.4	1.4	1.4	1.4
Max, speed	(min ⁻¹)		2,900	2,700	2,400	2,100	1,900
Max, speed (balanced)***	(min ⁻¹)		6,700	6,300	5,600	4,900	4,500

** at maximum bore diameter | *** higher speeds on request

ORDERING EXAMPLE	LP2	6000	340	50.8	90	XX
Model	●					Special designation only (e.g. special bore diameter tolerances, balancing, etc.). Contact R+W for more information.
Size		●				
Overall length (mm)			●			
Bore diameter Ø D1 H7				●		
Bore diameter Ø D2 H7					●	

For custom features place an XX at the end of the part number and describe the special requirements (e.g. LP2 / 6000 / 340 / 50.8 / 90 / XX - F7 bore tolerance on D2)